



ShareTech UTM Solution

Website
www.sharetech.com.tw/en-us

Sales Info
sales@sharetech.com.tw

Tech Support
help@sharetech.com.tw



SSL VPN for Android User Guide (Two-Step Verification)

Install OpenVPN Connect on Android devices for use with SSL VPN servers.
Android v15

1. Download the OpenVPN Connect app

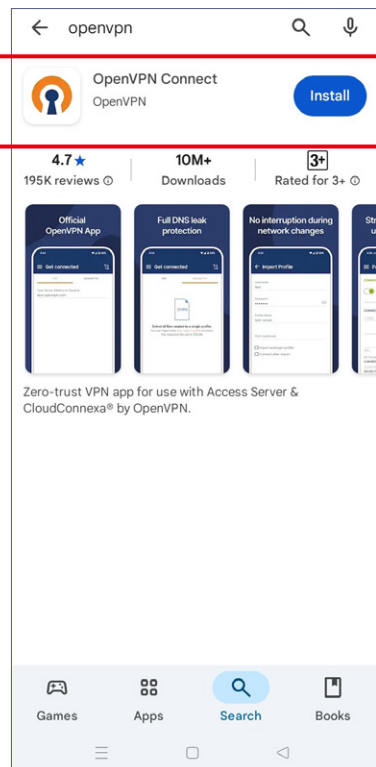

2. OpenVPN Android v3.7.1

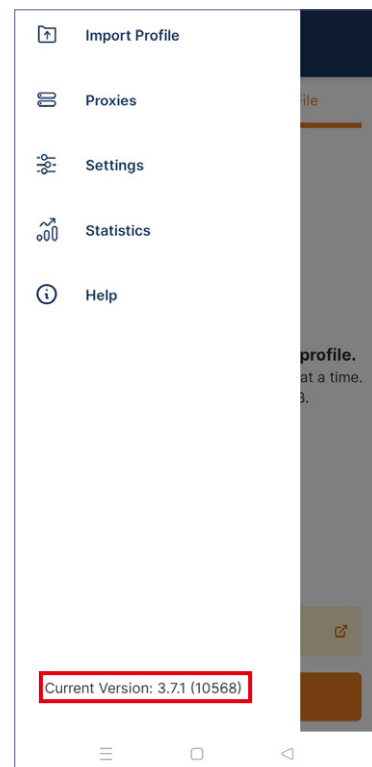

The IT administrator will provide the download link, or you may consult IT administrator for download instructions.

URL for example: [https://\[Wan IP Address or Domain\]:\[HTTPS Port\]/sslvpn.php](https://[Wan IP Address or Domain]:[HTTPS Port]/sslvpn.php)

[https://52.182.182.182\(IP\):4433/sslvpn.php](https://52.182.182.182(IP):4433/sslvpn.php) or <https://domain:4433/sslvpn.php>

3. Enter the IP (e.g., <https://domain:4433/sslvpn.php>) in the Chrome address bar.

Note: If your company has not imported the certificate, the “Your connection is not private” page will appear.

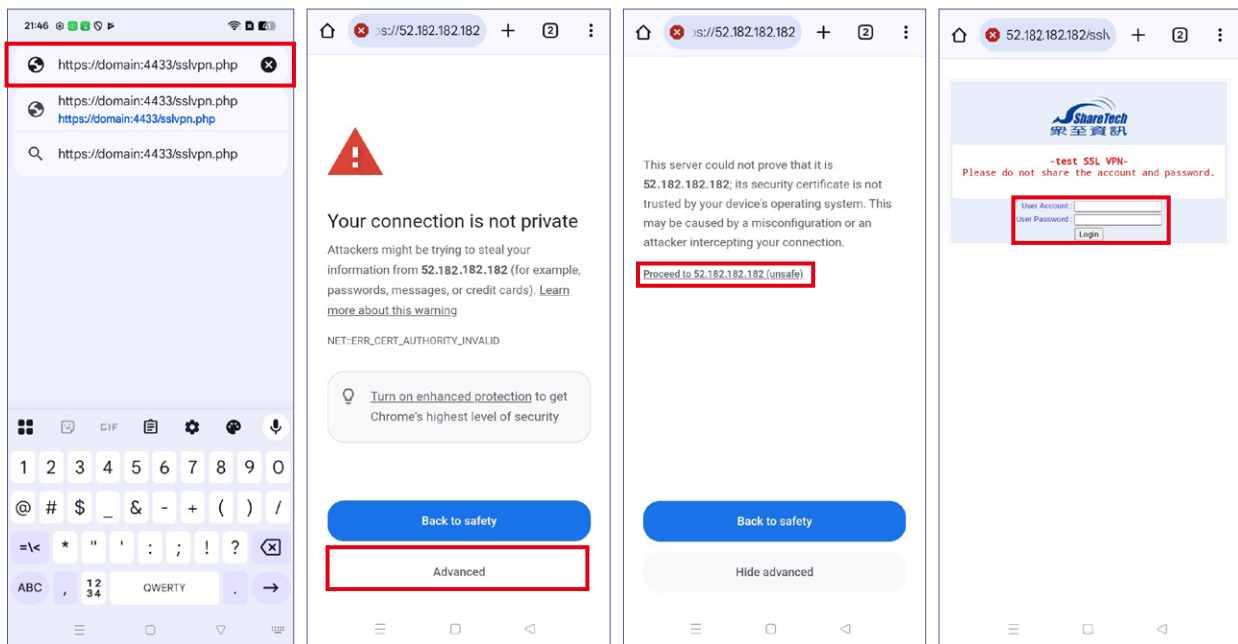

4. When two-step verification is required by your organization, this screen will be displayed.

Tap “Show Key” and copy the key. Enter one-time password code(552 295).

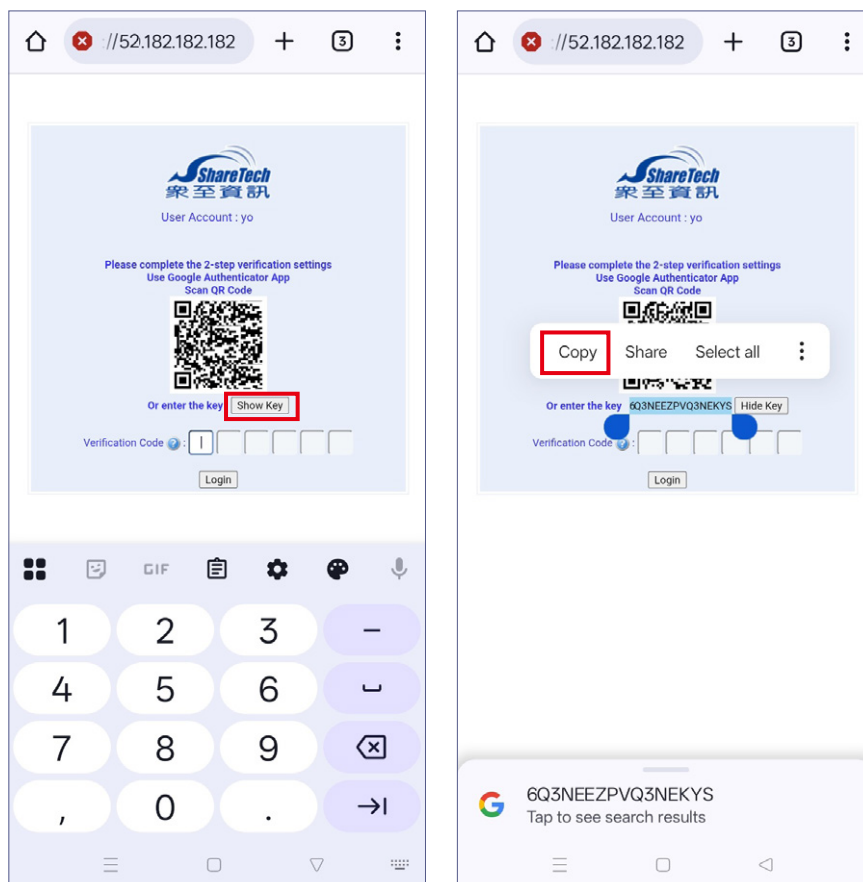

5. You can use Microsoft Authenticator, Google Authenticator, or a third-party authenticator.

Example: Download and install the Microsoft Authenticator app. It shows one-time Verification Code.

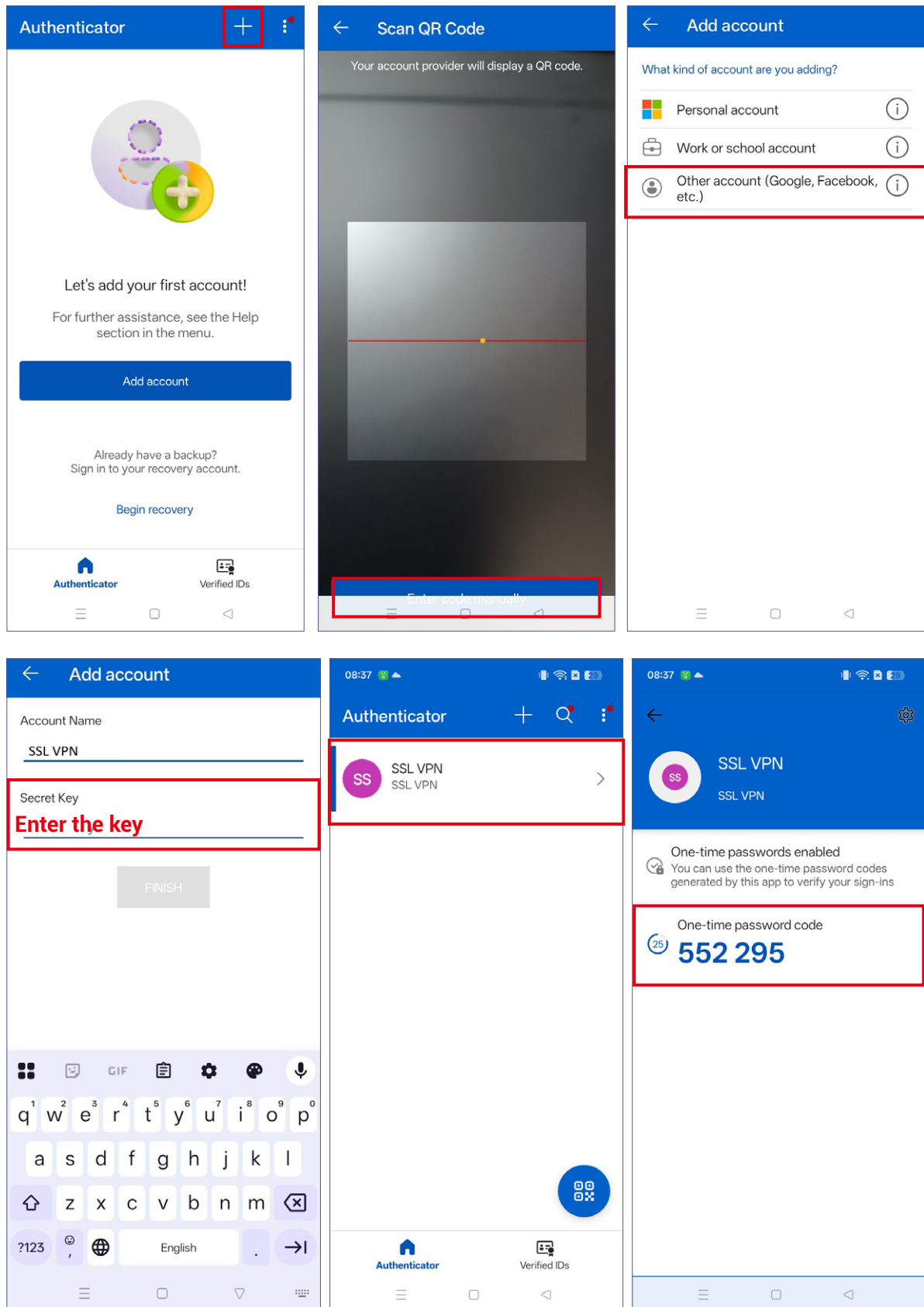

6. Choose Certificate (.ovpn) profile, and tap "Download"

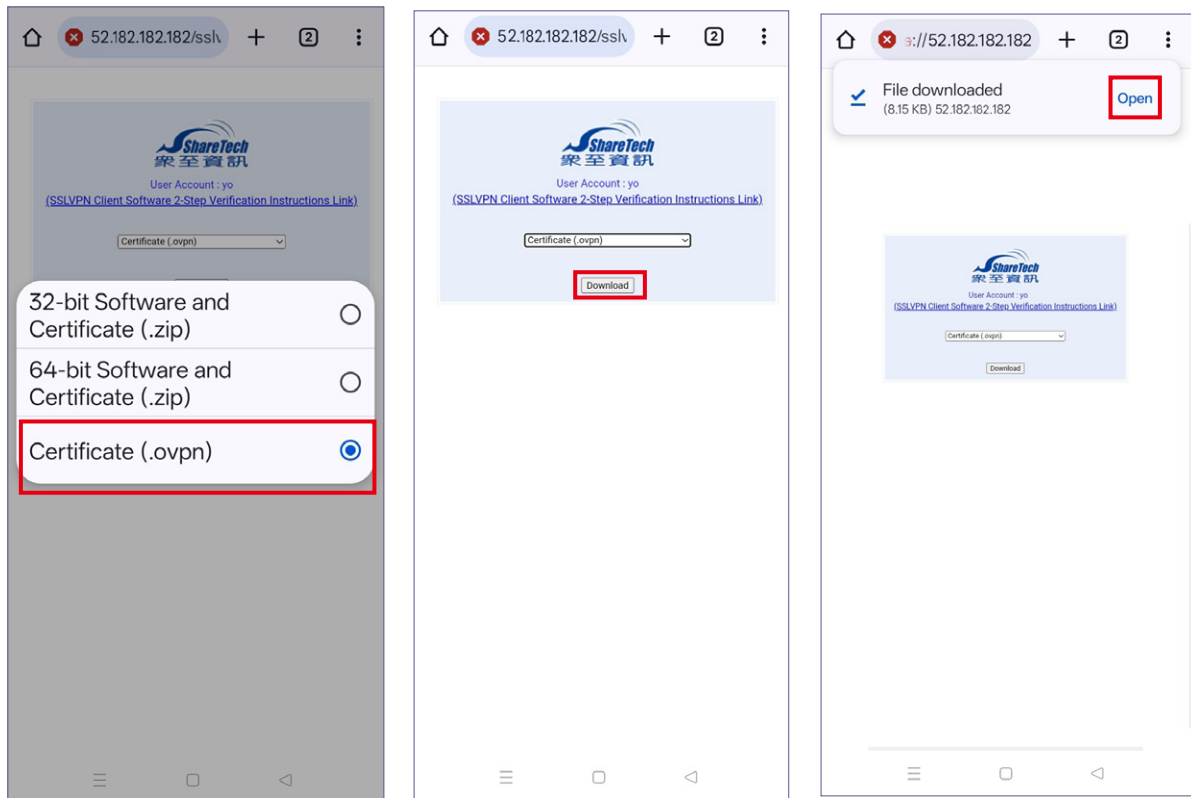

Tap sslvpn_account.ovpn profile, and open with [OpenVPN Connect APP](#)

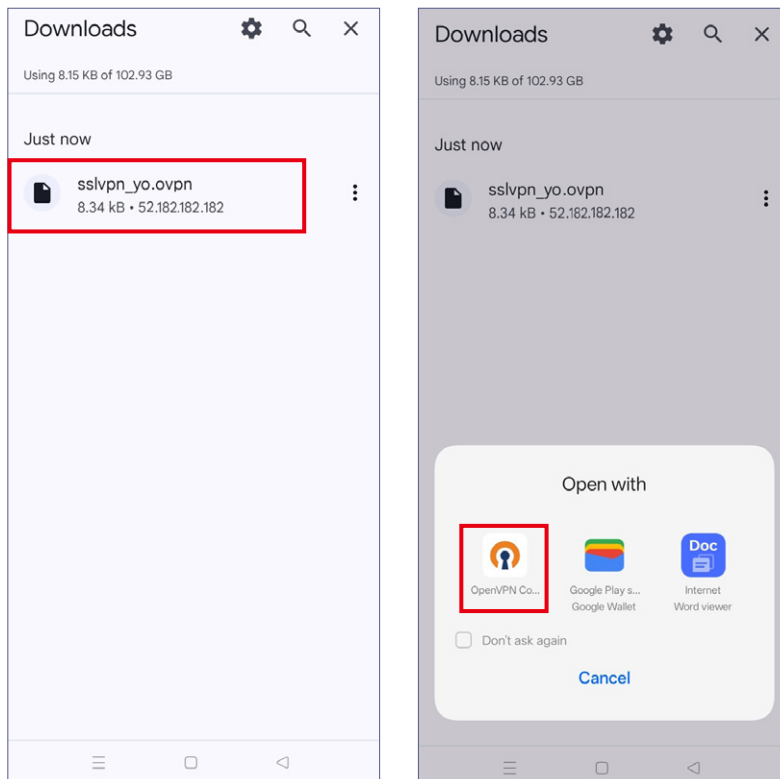

6-1. How to find downloaded files

Tap : Customize and control from Google Chrome. Or find “My Files” on your Phone.  

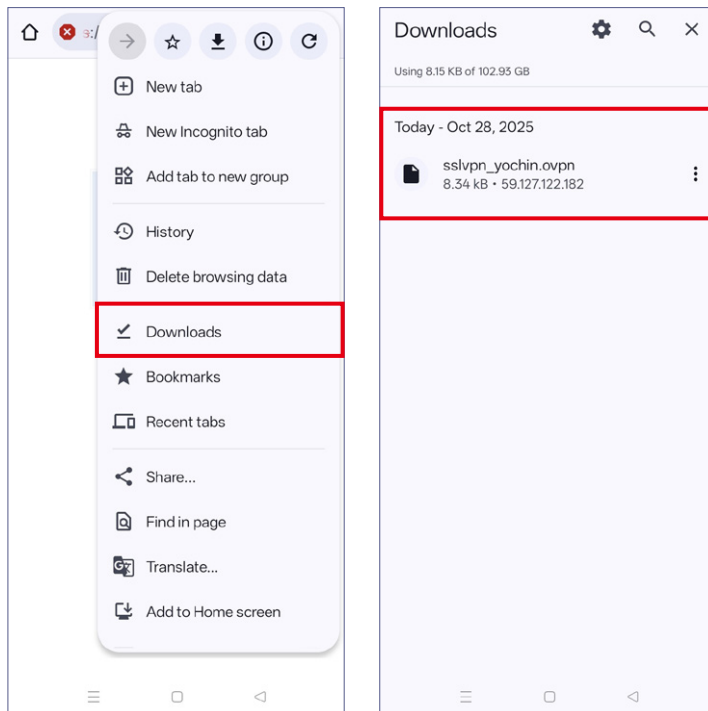

7. OpenVPN Connect app:

- Enter username.
- Enter Password.

When 2-step verification is enabled, you should enter the **password + verification code** in the password field.

For example: Password is **password**, verification code is **850945**

=> Password field needs to enter **password850945**

The allowable time difference for the verification code is one minute

- Connected.

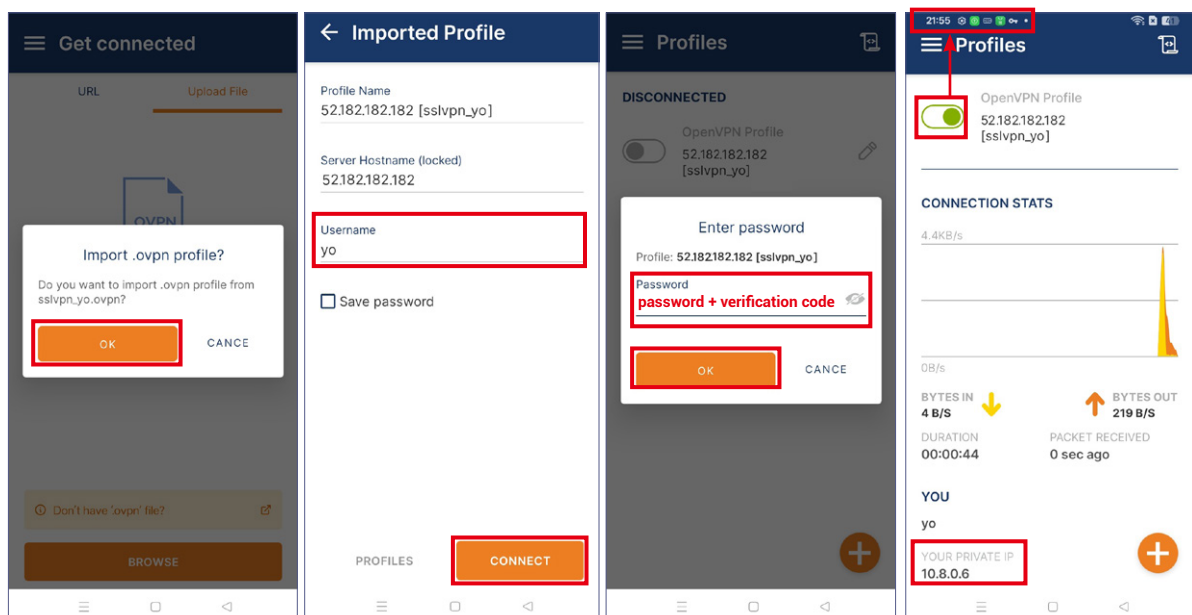

8. You also can check the VPN connection status from Settings.

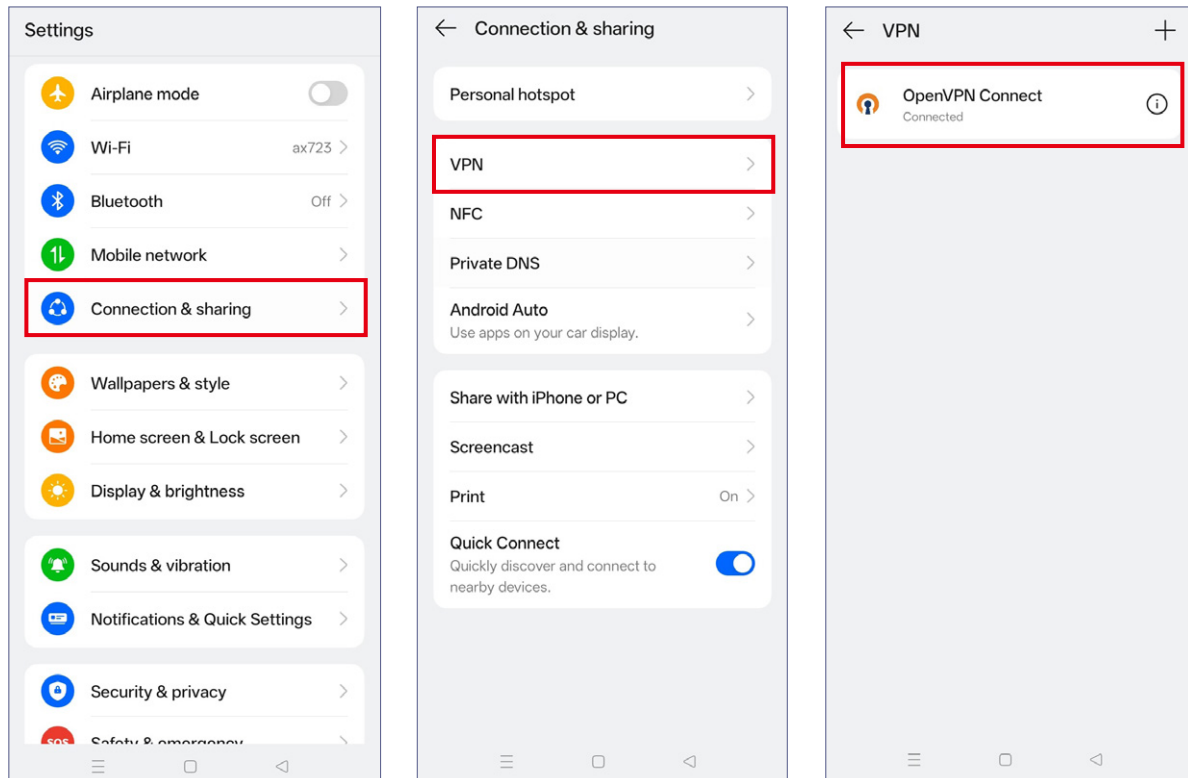

9. Once you have imported the profile, select the profile and tap "Connect" to connect to the SSL VPN server (Step 7).

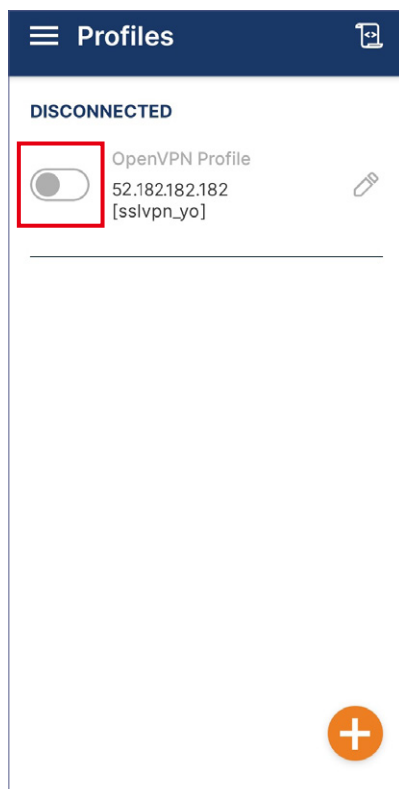

Besides, you can import your profile by doing the following:

